

TWM,HDM

INSTALLATION TOOLS

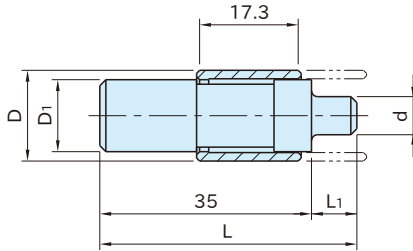

| Body |
|--|
| Steel(SUJ2) Quenched and tempered Black oxide finish |

| Type | Part Number | L | D | d | D ₁ | L ₁ | Weight (g) | Keylocking Inserts | |
|------------|--------------|------|----|------|----------------|----------------|------------|--------------------|-----------------|
| | | | | | | | | Carbon Steel | Stainless Steel |
| THIN WALL | TWM 5 | 42.5 | 11 | 3.8 | 7.8 | 7.5 | 19 | KIC0508 | KIC0508-SUS |
| | TWM 6 | | 13 | 4.6 | 9.9 | | 27 | KIC0610 | KIC0610-SUS |
| | TWM 8 | | 15 | 6.3 | 11.9 | | 38 | KIC0812 | KIC0812-SUS |
| | TWM10 | | 17 | 8.1 | 13.9 | | 51 | KIC1014 | KIC1014-SUS |
| | TWM12 | 45 | 19 | 9.8 | 15.8 | 10 | 65 | KIC1216 | KIC1216-SUS |
| HEAVY DUTY | HDM 4 | 42.5 | 11 | 3 | 7.8 | 7.5 | 18 | KIC0408 | KIC0408-SUS |
| | HDM 5 | | 13 | 3.8 | 9.9 | | 26 | KIC0510 | KIC0510-SUS |
| | HDM 6 | | 15 | 4.6 | 11.9 | | 37 | KIC0612 | KIC0612-SUS |
| | HDM 8 | | 17 | 6.3 | 13.9 | | 50 | KIC0814 | KIC0814-SUS |
| | HDM10 | 45 | 19 | 7.6 | 15.8 | 10 | 64 | KIC1016 | KIC1016-SUS |
| | HDM12 | | 21 | 9.8 | 17.9 | | 82 | KIC1218 | KIC1218-SUS |
| | HDM16 | | 25 | 13.5 | 21.9 | | 123 | KIC1622 | KIC1622-SUS |
| | HDM20 | | 33 | 16.9 | 29.9 | | 221 | KIC2030 | KIC2030-SUS |
| | HDM24 | | 36 | 20.4 | 32.9 | | 270 | KIC2433 | KIC2433-SUS |

How To Use

Used for hammer taps of **KIC**