

# TRIK

# PLASTIC THREE-LOBE KNOBS



Stainless Steel

Original Elesa Model VTT,VTT-CLEAN

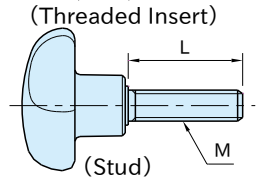
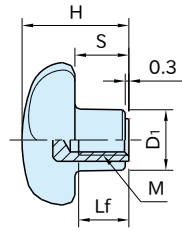
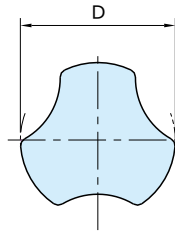

Knob	Threaded Insert/Stud
Polyamide (Glass-fiber reinforced) Black matte White matte	SUS304 Stainless steel

### Threaded Insert

Black Part Number	White Part Number	D	M	H	D <sub>1</sub>	S	Lf	Weight (g)
<b>TRIK25-M 5</b>	<b>TRIK25-M 5-CL</b>	25	M 5×0.8	20	12	10	10	9
<b>TRIK32-M 6</b>	<b>TRIK32-M 6-CL</b>	32	M 6×1	23	14	11.5		19
<b>TRIK40-M 8</b>	<b>TRIK40-M 8-CL</b>	40	M 8×1.25	27	16	13.5	13	24
<b>TRIK50-M10</b>	<b>TRIK50-M10-CL</b>	50	M10×1.5	30	19	15	17	37
<b>TRIK60-M12</b>	<b>TRIK60-M12-CL</b>	60	M12×1.75	34	22.5	18	20	61

### Stud

Black Part Number	D	M	H	D <sub>1</sub>	S	L	Weight (g)
<b>TRIK25-M 5×10</b>	25	M 5×0.8	20	12	10	10	8
<b>TRIK25-M 5×16</b>						16	9
<b>TRIK32-M 6×16</b>						16	15
<b>TRIK32-M 6×20</b>	32	M 6×1	23	14	11.5	20	16
<b>TRIK32-M 6×30</b>						30	19
<b>TRIK40-M 8×20</b>						20	28
<b>TRIK40-M 8×30</b>	40	M 8×1.25	27	16	13.5	30	32
<b>TRIK40-M 8×40</b>						40	36
<b>TRIK50-M10×20</b>						20	47
<b>TRIK50-M10×30</b>	50	M10×1.5	30	19	15	30	57
<b>TRIK50-M10×40</b>						40	67
<b>TRIK60-M12×30</b>						30	93
<b>TRIK60-M12×40</b>	60	M12×1.75	34	22.5	18	40	97
<b>TRIK60-M12×50</b>						50	100

### Features

- Solid design is perfect for use in application which emphasizes hygienic factors.
- Plastic knobs with stainless steel insert and stud are suitable for use on machines or equipment where frequent cleaning is required.

### Technical Information

Working temperature max. 130°C min. -30°C