

# STK

# PLASTIC LOBE KNOBS



Original ELESA Model VCT.



**STK-NT**  
(Tapped Through)



**STK-N**  
(Tapped Blind)



**STK-AE**  
(Tapped Blind,  
Self-Extinguishing)



**STK-N**  
(Stud)

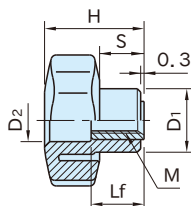
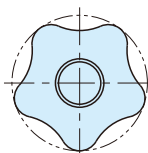
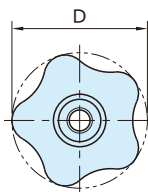

**STK-NT** (Tapped Through)

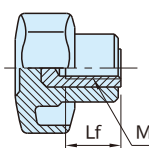
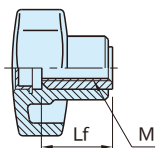

**STK-N** (Tapped Blind) and **STK25AE**

**STK-AE** (Tapped Blind, Self-Extinguishing)

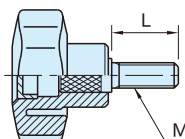

**STK-N** (Stud)

Type	Knob	Insert	Stud
<b>STK-NT</b>	Polypropylene plastic	Brass	Steel (SUM22L)
<b>STK-N</b>	Black matte		Zinc plated
<b>STK-AE</b>	Glass-fiber reinforced polyamide plastic Black matte		-

**STK-NT** (Tapped Through)

Part Number	D	H	D <sub>1</sub>	S	M	L <sub>f</sub>	D <sub>2</sub>	Weight (g)
<b>STK30NT</b>	32	23	15	10	M 6×1	12	10	10
<b>STK40NTA</b>	40	27	17	12				26
<b>STK40NT</b>					24			
<b>STK50NTA</b>	50	32	19	14	M 8×1.25	20	15	38
<b>STK50NT</b>								34
<b>STK60NT</b>	63	37	22	16	M12×1.75	26	19	47

## Features

The **STK-AE** type is self-extinguish. (UL94V-O certified).

## Notes

Use in hot or highly humid circumstances can deteriorate the plastic material properties.

## Technical Information

Working temperature : **STK-NT** **STK-N** 0°C to 90°C  
**STK-AE** -30°C to 150°C

**STK-N** (Tapped Blind)

Part Number	D	H	D <sub>1</sub>	S	M	L <sub>f</sub>	Weight (g)
<b>STK25N</b>	25	19	13	8	M 4×0.7	10	7
<b>STK25NA</b>					M 5×0.8		6
<b>STK30N</b>	32	23	15	10	M 6×1	12	10
<b>STK40NA</b>	40	27	17	12		M 8×1.25	18
<b>STK40N</b>					24		
<b>STK50NA</b>	50	32	19	14	M10×1.5	20	38
<b>STK50N</b>							34
<b>STK60N</b>	63	37	22	16	M12×1.75	26	40

**STK-AE** (Tapped Blind , Self-Extinguishing)

Part Number	D	H	D <sub>1</sub>	S	M	L <sub>f</sub>	Weight (g)
<b>STK25AE</b>	25	19	13	8	M 5×0.8	10	6
<b>STK30AE</b>	32	23	15	10	M 6×1	12	11
<b>STK40AE</b>	40	27	17	12	M 8×1.25	18	24
<b>STK50AE</b>	50	32	19	14	M10×1.5	26	34

**STK-N** (Stud)

Part Number	D	H	D <sub>1</sub>	S	M	L	Weight (g)
<b>STK25×10N</b>	25	19	13	8	M 5×0.8	10	7
<b>STK25×16N</b>						16	8
<b>STK25×20N</b>						20	9
<b>STK25×10NA</b>					M 6×1	10	8
<b>STK25×16NA</b>						16	9
<b>STK25×20NA</b>						20	10
<b>STK25×30NA</b>		30	12				
<b>STK30×16N</b>	32	23	15	10	M 6×1	16	13
<b>STK30×20N</b>						20	14
<b>STK30×30N</b>						30	16
<b>STK40×25NA</b>	40	27	17	12	M 6×1	25	19
<b>STK40×25N</b>						25	26
<b>STK40×35N</b>					M 8×1.25	35	28
<b>STK40×45N</b>						45	32
<b>STK40×55N</b>						55	36
<b>STK50×20NA</b>	50	32	19	14	M 8×1.25	20	28
<b>STK50×30NA</b>						30	31
<b>STK50×30N</b>					M10×1.5	30	41
<b>STK50×40N</b>						40	46
<b>STK50×50N</b>						50	51
<b>STK60×30N</b>	63	37	22	16	M12×1.75	30	67
<b>STK60×50N</b>						50	79