

# SRH4

# STAINLESS STEEL EQUIPMENT HANDLES



**SRH4-A SRH4-B**  
(Straight)



**SRH4-C**  
(Cranked)

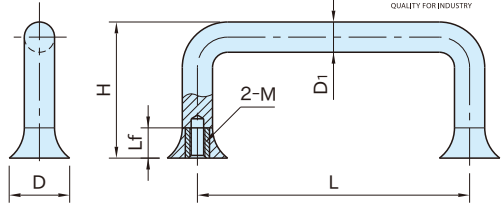

**SRH4-A SRH4-B**  
(Straight)

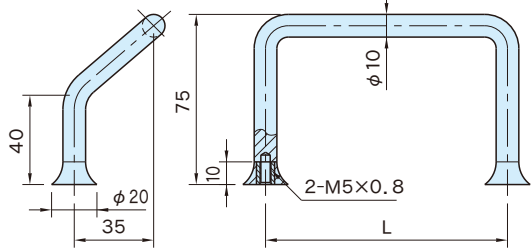
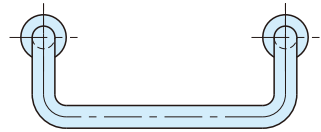

**SRH4-C**  
(Cranked)

Body
Stainless steel(SUS303)

**SRH4-A SRH4-B** (Straight)

Part Number	L	H	D	D <sub>1</sub>	M	L <sub>f</sub>	Load Capacity (N)	Weight (g)
<b>SRH4-100A</b>	100	45	20	10	M5×0.8	10	1000	111
<b>SRH4-120A</b>	120							124
<b>SRH4-120B</b>		60	30	15	M6×1	12		310
<b>SRH4-140B</b>	320							
<b>SRH4-200B</b>	200	420						

**SRH4-C** (Cranked)

Part Number	L	Load Capacity (N)	Weight (g)
<b>SRH4-100C</b>	100	1000	168
<b>SRH4-120C</b>	120		180

## Features

- The trumpetlike shape of the handle feet allows for easy cleaning.
- Perfect for use in hygienic environments.

## Furnished With

- Stainless-steel hex. head screws  
**SRH4-A SRH4-C** : M5×0.8-10L    **SRH4-B** : M6×1-12L
- Stainless-steel washers  
**SRH4-A SRH4-C** : M5-screw washers    **SRH4-B** : M6-screw washers