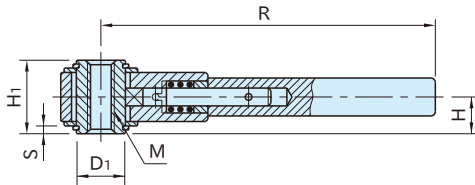
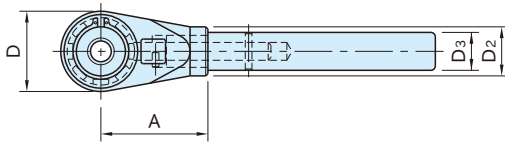
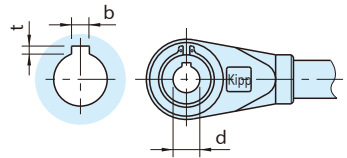
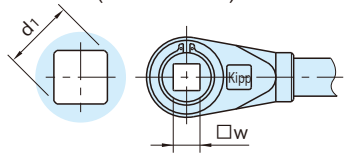

RL**RACHET LEVERS****RL-T**
(Tapped Hole)**RL-R**
(Round Hole)**RL-S**
(Square Hole)

Body	Lever	Hub
Steel(SCM421) (RL400:Steel(S35C)) Black oxide finish	Steel(SUM22L) Black oxide finish	Steel(SUM22L) Carburized-hardened Black oxide finish Heat treated to Rc58-63

**RL-T**
(Tapped Hole)**RL-R**
(Round Hole)**RL-S**
(Square Hole)

Type / Size	No. of Teeth	R	H	D	H ₁	D ₁	D ₂	D ₃	S	A	
RL-T	150	7	150	15.5	36	31	22	22	17	3	48
	180	8	180	19	43	38	27	26	20	4	54
RL-R	230		230	21	51	42	35	30	24		70
RL-S	300		9	300	23.5	61	47	42	35		28
	400	11	400	26.5	82	53	60	38	32	5	110

RL-T (Tapped Hole)

Part Number	M	Weight (g)
RL150T	M12×1.75	460
RL180T	M16×2	760
RL230T	M20×2.5	1,350
RL300T	M24×3	2,300
RL400T	M36×4	4,200

RL-R (Round Hole)

Part Number	d (H7)	b (Js9)	t	Weight (g)
RL150R	12	4	1.8	460
RL180R	16	5	2.3	760
RL230R	20	6	2.8	1,350
RL300R	25	8	3.3	2,300
RL400R	30			4,200

RL-S (Square Hole)

Part Number	w (H11)	d ₁	Weight (g)
RL150S	12	16.05	460
RL180S	14	17.98	760
RL230S	17	22.05	1,350
RL300S	22	26.57	2,300
RL400S	32	41.83	4,200

How To Use

1 The click is engaged with the ratchet.

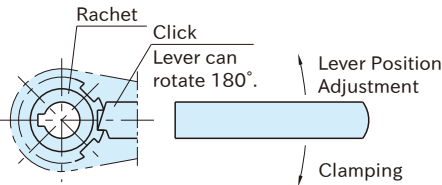

2 Pulling the lever allows disengaging the click from the ratchet, for 180° rotation.

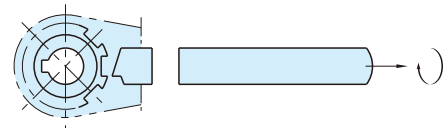

3 Releasing the lever allows the return spring to engage the click with the ratchet again, for change of clamping direction.

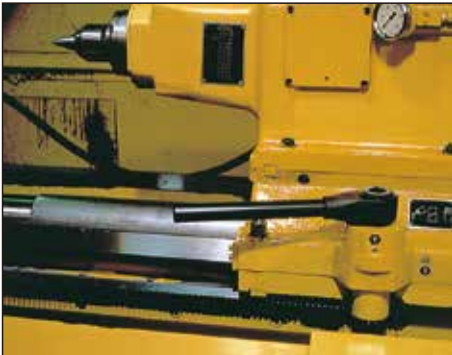
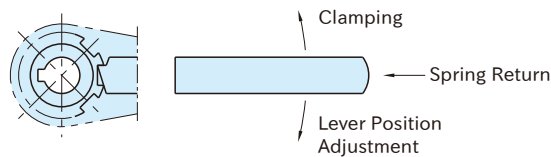

Technical Information

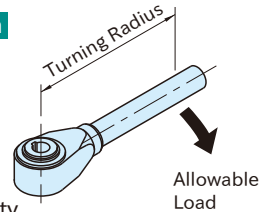

Clamping Capacity

Type/Size	RL-T		RL-R	RL-S	
	150	180	230	300	400
Turning Radius	123	154	210	260	360
Allowable Load (N)	300	350	400	600	750
Max. Torque (N·m)	36.9	53.9	84	156	270