

QCSJLK

SHAFT COUPLING CLAMP WITH SAFETY LOCK



Stainless Steel

Heat resistance: 180°C



★ Key Point

Safety lock for axial & rotational force

Part Number	Weight (g)
QCSJLK1118A	41

Note

Spring pin for fixing the shaft is not supplied.

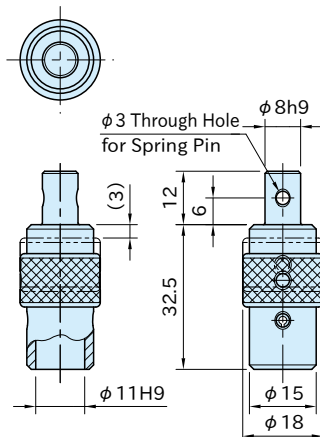

Body/Collar	Pin	Spring
SUS303 stainless steel	SUS420J2 stainless steel	SUS304WPB stainless steel

QCSJLK-S

LOCKING RECEPTACLE



Stainless Steel

Heat resistance: 180°C

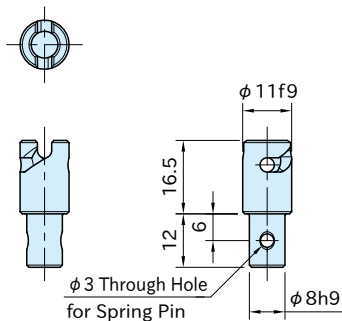

Body
SUS303 stainless steel

Part Number	Weight (g)
QCSJLK1118-S	13

Note

Spring pin for fixing the shaft is not supplied.

Feature

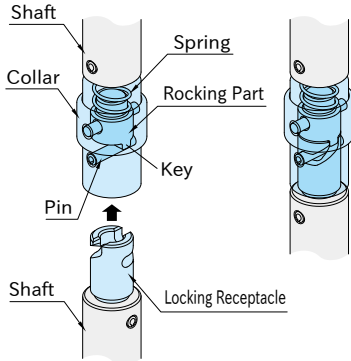

The pin cannot be pulled out when it reaches the end of the cam groove. The keys on the locking part stop the rotation.

How To Use

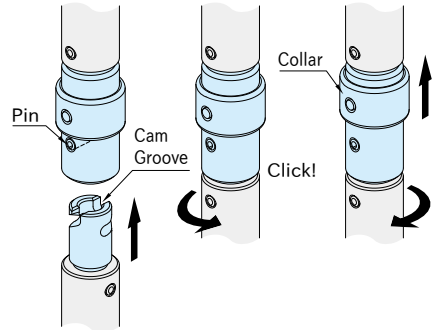

1. Align the cam groove with the pin and insert.
2. Turn the shaft for 90° to clamp and it clicks when clamped.
3. Push up the collar for unclamping and turn the shaft by 90°.

Technical Information

- Heatresistant Temperature 180°C
- Mechanical Strength/Allowable Torque/Runout Angle

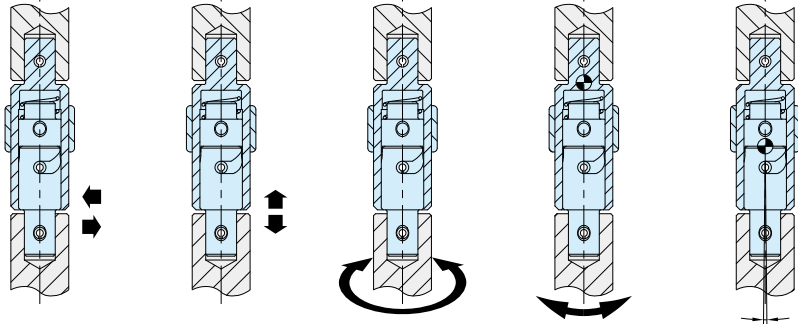

Shear Strength 2000N Tensile Strength 1200N Allowable Torque 10N·m Allowable Bending Moment 15N·m Runout Angle Max. 0.9°

Application Example

Change of suction pads

SHAFT COUPLING CLAMP
WITH SAFETY LOCK
QCSJLK1118A



LOCKING RECEPTACLE
QCSJLK1118-S

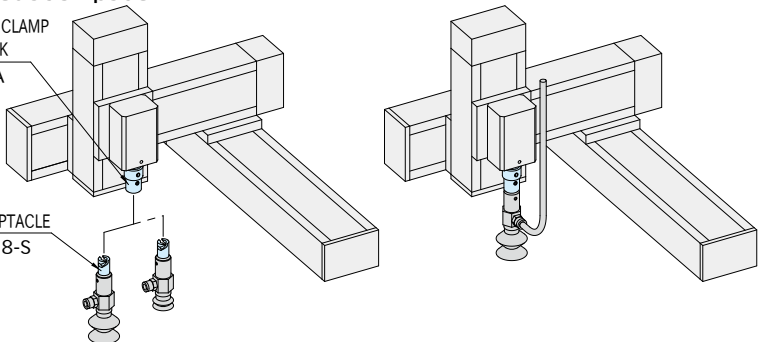

Continuing on Next Page

Application Example

Change of spindle shafts

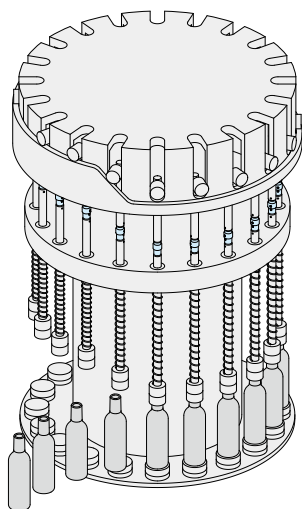

SHAFT COUPLING CLAMP
WITH SAFETY LOCK
QCSJLK1118A

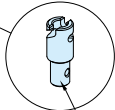
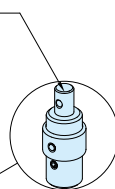

LOCKING RECEPTACLE
QCSJLK1118-S

Detachment of handwheel to prevent accidental operation

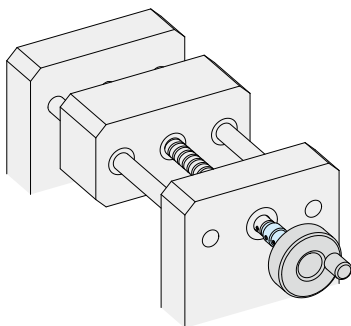

SHAFT COUPLING CLAMP
WITH SAFETY LOCK
QCSJLK1118A



LOCKING RECEPTACLE
QCSJLK1118-S



How To Install

Shaft Coupling Clamp With Safety Lock

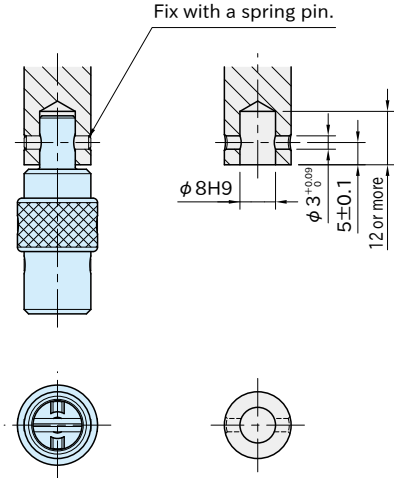

Locking Receptacle

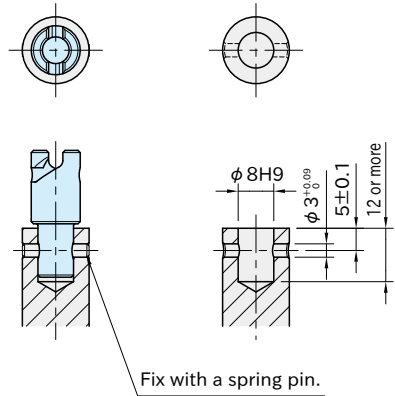

Installation Dimension

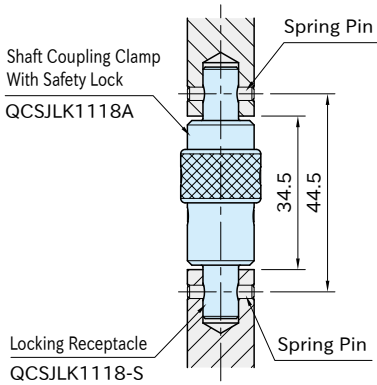

Note

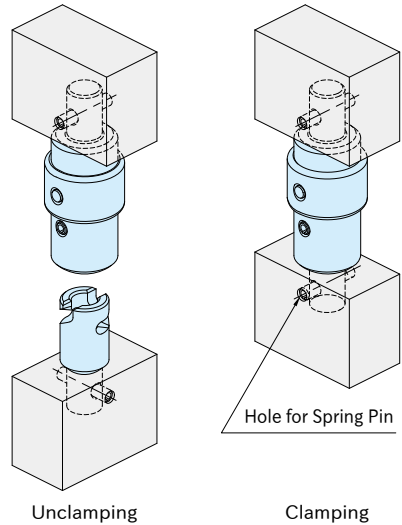

Decide the mounting hole position depending on the part direction at the locking position.