

QCPC-M

CLAMPING PIN

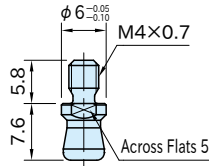

Stainless Steel



Body
SUS630 stainless steel Precipitation hardened

Part Number	Weight (g)	Proper pneumatic pin holding clamps
QCPC0625-M4-SUS	2	PPHC0621S-SUS, PPHC0623D-SUS

Note: Spacing tolerance for multiple use should be ± 0.1 .
Refer to the product pages of clamps for repeatability.

Note

Color difference by the hardening treatment does not affect function or quality of the product.

How To Install

Hole Preparation

