

PGL LEVER ARMS



PGL



PGL-SUS

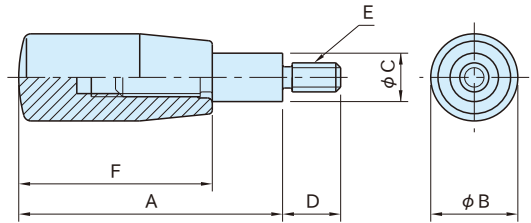

Type	Knob	Arm
PGL	Phenolic plastic Glossy Finish Black	Steel (SS400) Hard chrome plated finish Satin finish Silver matte
PGL-SUS		Stainless steel (SUS303)

Steel	Stainless Steel	A	B	C	D	E	F	Weight (g)
Part Number	Part Number							
PGL 6× 63	PGL 6× 63-SUS	63	18	10	12	M 6×1	40	38
PGL 6× 80	PGL 6× 80-SUS	80						49
PGL 6×100	PGL 6×100-SUS	100						61
PGL 8× 80	PGL 8× 80-SUS	80	21		20	M 8×1.25	50	57
PGL 8×100	PGL 8×100-SUS	100						73
PGL 8×125	PGL 8×125-SUS	125						85
PGL10×100	PGL10×100-SUS	100	23	12	25	M10×1.5	65	82
PGL10×125	PGL10×125-SUS	125						112
PGL10×160	PGL10×160-SUS	160						154
PGL12×125	PGL12×125-SUS	125	26	14	30	M12×1.75	80	166
PGL12×160	PGL12×160-SUS	160						208
PGL12×200	PGL12×200-SUS	200						256

- The knob is pressed onto the arm and glued.
- Working temperature : Between -20°C and 110°C