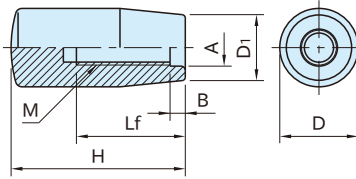
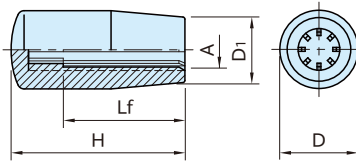

**PG****TAPERED HANDLES**

Original ELESA Model I.580N, I.280

**PG**  
(Tapped)**PG-N**  
(Self-Locking)**PG**  
(Tapped)**PG-N**  
(Self-Locking)

Note: PG65N-12, PG80N-14 bores are not ribbed.

Type	Body
<b>PG</b>	Phenolic plastic Glossy Finish Black
<b>PG-N</b>	Polypropylene plastic Black matte

**PG** (Tapped)

Part Number	D	D <sub>1</sub>	H	M	Lf	A	B	Weight (g)
<b>PG 28</b>	14	11	28	M 5×0.8	12	5.5	1.5	5
<b>PG 40A</b>	18	15	40	M 6×1	25	6.5	3.5	12
<b>PG 40</b>				M 8×1.25		8.5		
<b>PG 50A</b>	21	17	50	M 6×1	35	6.5	7.5	21
<b>PG 50</b>				M 8×1.25		8.5		20
<b>PG 65A</b>	23	19	65	M10×1.5	30	10.5	7	33
<b>PG 65</b>					40			30
<b>PG 80A</b>	26	21	80	M12×1.75	55	12.5	10	47
<b>PG 80</b>								10.5
<b>PG 90A</b>	28	22	90	M10×1.5	58	12.5	8	62
<b>PG 90</b>								90
<b>PG100</b>	31	25	102	M12×1.75	58	12.5	8	90
<b>PG115</b>	29	23	116					88

**PG-N** (Self-Locking)

Part Number	D	D <sub>1</sub>	H	A	Lf	Weight (g)
<b>PG40N</b>	18	15	40	8	28	8
<b>PG50N</b>	21	17	50	10	35	10
<b>PG65N</b>	23	19	65		45	17
<b>PG65N-12</b>				12	16	
<b>PG80N</b>	26	21	80	14	50	25
<b>PG80N-14</b>					24	
<b>PG90N-15</b>	28	22	90	15	60	33

**Technical Information**

Working temperature :  
 Between -20°C and 110°C for **PG** type  
 Between 0°C and 80°C for **PG-N** type

**Features:**

Push-fit handle that can accept a commercially available bright steel bar finished to h9 tolerance.