

PB / PC

PLASTIC BALL KNOBS



PB-R
(Without Insert, Red)



PC-B
(With Insert, Black)

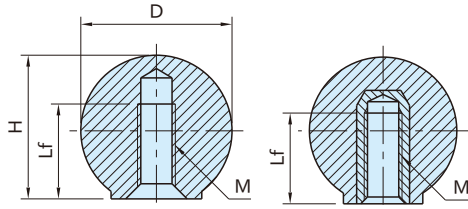

PB
(Without Insert)

PC
(With Insert)

Body	Insert(PC only)
ABS plastic R:Red, B:Black	Brass (C3604B)

PB (Without Insert)

Red	Black	D	H	M	Lf	Weight (g)
Part Number	Part Number					
PB20× 5R	PB20× 5B	20	19	M 5×0.8	10	5
PB20× 6R	PB20× 6B			M 6×1		
PB25× 6R	PB25× 6B	25	24	M 8×1.25	14	10
PB25× 8R	PB25× 8B					
PB32× 8R	PB32× 8B	32	30	M 10×1.5	20	20
PB32×10R	PB32×10B					
PB40×10R	PB40×10B	40	38	M 12×1.75	22	40
PB40×12R	PB40×12B					
PB50×12R	PB50×12B	50	48	M 16×2	25	85
PB50×16R	PB50×16B					

PC (With Insert)

Red	Black	D	H	M	Lf	Weight (g)
Part Number	Part Number					
PC20× 5R	PC20× 5B	20	19	M 5×0.8	8	7
PC20× 6R	PC20× 6B			M 6×1		
PC25× 6R	PC25× 6B	25	24	M 8×1.25	12	15
PC25× 8R	PC25× 8B					
PC32× 8R	PC32× 8B	32	30	M 10×1.5	15	25
PC32×10R	PC32×10B					
PC40×10R	PC40×10B	40	38	M 12×1.75	18	30
PC40×12R	PC40×12B					
PC50×12R	PC50×12B	50	48	M 16×2	25	55
PC50×16R	PC50×16B					

- A slightly tapered tapped hole in the **PB** knobs provides positive lock.
- If an adhesive agent is applied, it should be adaptive to the ABS plastic.
- Use in hot or highly humid circumstances can deteriorate the plastic material properties.