



**OG-N** -BR  
(Self-Locking, Black)



**OG-N** -RE  
(Self-Locking, Red)



**OG-N** -CL  
(Self-Locking, White)

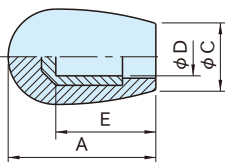
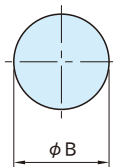

**OG**  
(Self-Locking, Inserted)

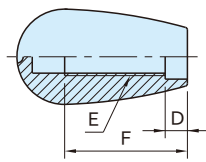

**OG-M**  
(Tapped)

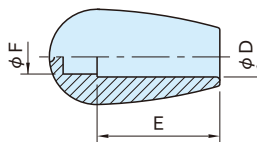

**OG-N**  
(Self-Locking)

Type	Knob	Insert
<b>OG</b>	Phenolic plastic Glossy Finish Black	Polyamide plastic White
<b>OG-N</b>	Polyamide plastic Glossy Finish Black, Red, or White	-
<b>OG-M</b>	Polyamide plastic Glossy Finish Black	-

**OG** (Self-Locking, Inserted)

Black Part Number	A	B	C	D	E	Weight (g)
<b>OG25</b>	25	15	12	6	17	5
<b>OG30</b>	31	20	14	8	21	9
<b>OG40</b>	42	26	17	10	30	18
<b>OG55</b>	54	33	20	12	40	40
<b>OG70</b>	68	38	23	14	50	68
<b>OG90</b>	87	41	25	16	58	106

**OG-N** (Self-Locking)

Black	Red	White	A	B	C	D	E	F	Weight (g)
Part Number	Part Number	Part Number							
OG25N -BR	OG25N -RE	OG25N -CL	25	16	12	6	17	4	4
OG30N -BR	OG30N -RE	OG30N -CL	32	20	14	8	21	6	7
OG40NA-BR	OG40NA-RE	-	42	26	17		25		16
OG40N -BR	OG40N -RE	OG40N -CL				10	30	7.5	14
OG55NA-BR	OG55NA-RE	OG55NA-CL	54.5	34	21		40	5.5	38
OG55N -BR	OG55N -RE	OG55N -CL				12			36

## OG-M (Tapped)

Black	A	B	C	D	E	F	Weight (g)
Part Number							
OG25M	25	16	12	3.5	M 6×1	16	4
OG30M	32	20	14		M 8×1.25	20	7
OG40MA	42	26	17	5	M10×1.5	30	18
OG40M							16
OG55MA	54.5	34	21	8	M12×1.75	35	34
OG55M							35

## Features

Self-locking and threaded insert types are available. The polyamide self-locking insert provides easy press-fit mounting on a plain shaft and allows preventing the knob from getting loose through successive receipt of vibrations.

- No need to thread a shaft. Knobs can accept a commercially available bright steel bar finished to h9 tolerance.
- Elastic polyamide insert provides firm gripping that is not affected by vibrations or normal pull-out force.
- Knobs can be repeatedly loaded and unloaded up to several times.

## Technical Information

Working temperature : Between  $-20^{\circ}\text{C}$  and  $110^{\circ}\text{C}$  for **OG** type  
 Between  $-20^{\circ}\text{C}$  and  $50^{\circ}\text{C}$  for **OG-N** type  
 Between  $-20^{\circ}\text{C}$  and  $90^{\circ}\text{C}$  for **OG-M** type

## Strength Data **OG-N** (Self-Locking)

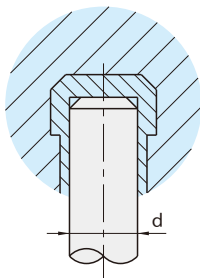

Shaft Dia d h9	Pull-Out Strength (N)
6	500
8	600
10	750
12	1200
14	1400
16	1600

Note : The above pull-out strength denotes the values that resulted from tests under certain conditions. A safety factor should be taken into consideration.