

NTWN, TWN

PLASTIC ANGLED-SPOKE HANDWHEELS



Original Elesa Model VRTP.



NTWN

(Without Handle)



TWN-F

(With Revolving Fold-Away Handle)



TWN-G

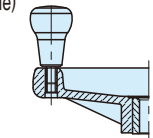

TWN-G

(With STG Revolving Handle)

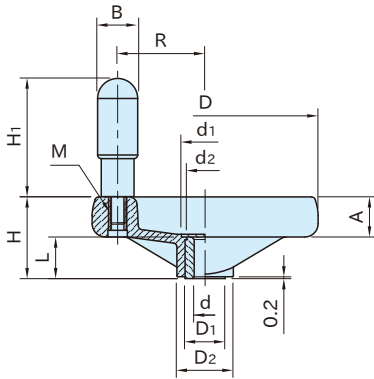

TWN

(With Revolving Handle)

For 375 Dia. Handwheels

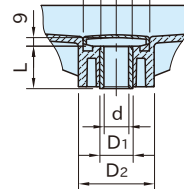

TWN-F

(With Revolving Fold-Away Handle)

Center cap color is selectable from 6 colors.



Type	Handwheel	Hub	Center Cap			Handle
			Color: Un-selectable		Color: Selectable	
			80-300 dia. handwheels	375 dia. handwheels		
NTWN	Polypropylene plastic Black matte	Steel (SUM24L) Black oxide finish	Aluminum(A3104) Silver matte	Polyester plastic Gray bright	Polyamide plastic Black matte, orange matte, gray matte, yellow matte, light blue matte or red matte	-
TWN						Polyamide plastic Black matte
TWN-F					-	Polypropylene plastic Coated with thermoplastic elastomer Black matte
TWN-G					-	

Part Number	D	H	A	D ₂	L	D ₁	d (H7)	d ₁	d ₂	
NTWN	80	80	35	18	25	17	8	20.5	16	
	100	99	37	20	25.5		10			
TWN	125	125	44	22	31	22	12	26	20	
	160	160	51	25	40	27	14	31	24	
TWN-G	200	200	61	28	48.5	34	30	16	36	28
	250	250	69	32	58	38	35	20	44	33
TWN-F	300	300	78	35.5	66	43	40	52	37	
	375	375	87	39	81		35	26	70	33

NTWN (Without Handle)

Part Number	Weight (g)
NTWN 80	74
NTWN100	100
NTWN125	160
NTWN125-**	
NTWN160	275
NTWN160-**	
NTWN200	460
NTWN200-**	
NTWN250	730
NTWN300	970
NTWN375	1,287

** Complete with color code for a center cap.

TWN (With Revolving Handle)

Part Number	B	H ₁	M	R	Weight (g)
TWN 80	15.5	45	M 6×1	29	104
TWN100	18	60		37	145
TWN125	22	65	M 8×1.25	48	245
TWN125-**					
TWN160	23	73	M 10×1.5	65	356
TWN160-**					
TWN200	24	80		84	552
TWN200-**					
TWN250	25	90		105	904
TWN300					
TWN375				160	1,240

** Complete with color code for a center cap.

TWN-G (With STG Revolving Handle)

Part Number	B	H ₁	M	R	Weight (g)
TWN250G	45	65	M10×1.5	105	914
TWN300G				127	1,121
TWN375G				160	1,260

■ Ordering Example for 125-200 diameter handwheels.

Color Code	Center-Cap Color
OG	Orange
GR	Gray
YE	Yellow
LB	Light blue
BR	Black
RE	Red

NTWN125 - BR

Part Number	Color Code
NTWN125	BR

Orange Gray Yellow

Light blue Black Red

TWN-F (With Revolving Fold-Away Handle)

Part Number	B	H ₁	R	Weight (g)
TWN 80F	15.5	45	29	102
TWN100F	18	60	37	163
TWN125F	22	65	48	230
TWN125F-**				
TWN160F	23	73	65	388
TWN160F-**				
TWN200F	24	80	84	593
TWN200F-**				
TWN250F	25	90	105	932
TWN300F			123	1,210
TWN375F			160	1,402

** Complete with color code for a center cap.

Features

- Resistant to impact shock, and many acids alkalis and greases.
- Ergonomically designed rim provides a more comfortable grip.
- The boss hole can be covered easily with attached center cap by press-fit (for plastic center cap) or adhesive tape (for aluminum center cap).
- The center cap can be removed by pushing it up from below.
- The handle of the **TWN-F** handwheel can be folded away only after being pulled up.

Note

- The **NTWN** handwheel is not provided with a handle-mounting hole.
- The center cap of 125-200 diameter handwheels available from 6 colors. The standard aluminum cap (silver matte) will be included together.
- A handwheel and a colored center cap are not supplied in assembly (packed separately).

Technical Information

Working temperature: Between 0°C and 80°C

■ Strength Data

Wheel Dia.	Max. Torque T ₁ (N·m)	Impact Strength S ₁ (J)
80	32	5
100	54	7
125	94	10
160	185	15
200	300	24
250	420	28
300	480	36
375	380	55

