

NIS-S STEEL IDLE SPROCKETS

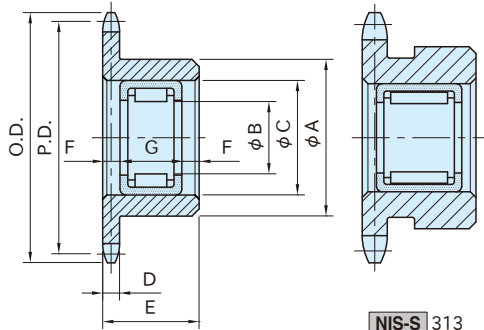

NIS-S 219, 420~812

NIS-S 313

Sprocket	Bearing
Steel (S45C) Induction hardened (teeth top) Black oxide finish	Steel

Part Number	Chain No.	No. of Teeth	O. D.	P. D.	A	B	C	D	E	F	G
NIS219S	25	19	41.5	38.58	26	12	19	2.8	16	0.5	15
NIS313S	35	13	44	39.80	32			4.3	20		
NIS420S	40	20	88	81.18	67	25	33	7.2	25	2.5	20
NIS516S	50	16	89	81.37	62			8.7			
NIS614S	60	14	95	85.61	62			11.7	32	6	
NIS812S	80	12	108	98.14	67			14.6	40	5	

Part Number	Bearing	Weight (g)	Proper Idler Pin
NIS219S	TA1215Z	50	SID1203
NIS313S		100	
NIS420S	TA2520Z	500	SID2506
NIS516S		615	
NIS614S		840	
NIS812S	TA2530Z	1,200	SID2508

- Available with needle bearing.
- **NIS219S** Idle Sprocket is not induction hardened on the teeth top.

Technical Data

Allowable Bearing Radial Loads (N)
 <for 3,000 hours of average service life>

Bearing	Speed (min ⁻¹)					
	100	200	300	500	1000	1500
TA1215Z	2980	2420	2160	1840	1490	1320
TA2520Z	7730	6280	5560	4770	3870	3430
TA2530Z	11300	9170	8120	6980	5660	5010