

MVAC-VP

INSERTS FOR VERTICAL USE

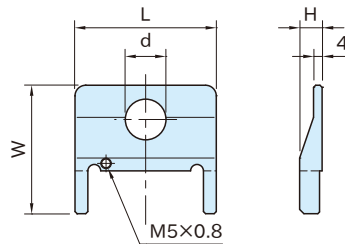

Body
Aluminum

Part Number	L	W	H	d	Weight (g)
MVAC110VP	52	50	9.5	15	36
MVAC150VP	66	60	10.5	19	50

Notes:

Use to prevent drop of the unit for vertical use of the vise.

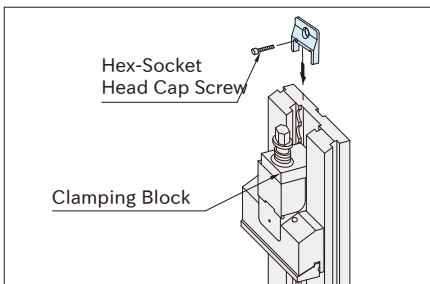

Set the insert in the slot of the base.
Prevent slip off of the movable jaw.
To hold the insert, use the included hex-socket setscrew as needed.

Furnished Parts

1 pc. of Hex-Socket Head Cap Screw