

MBFC

FIXTURE CLAMPS

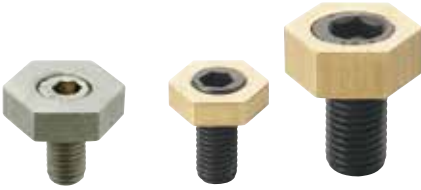

Stainless Steel



MBFC-SUS
(Stainless Steel)

MBFC
(Brass)

Type	Cam Screw	Hexagonal Washer
MBFC	SCM440 steel Quenched & tempered Black oxide finished HRC38~45	Brass
MBFC-SUS	SUS304	SUS303

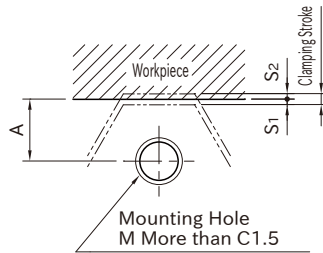
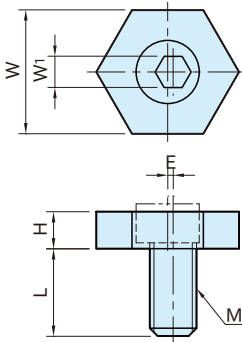

*) Dimension A is the recommended distance between the mounting hole and the end of the workpiece.

MBFC (Brass)

Part Number	A	E	S ₁	S ₂	W	H	M	L	W ₁	Clamping Force (N)
MBFC04	3.8	0.38	0.23	0.53	7.9	2.8	M 4×0.7	9.5	3	900
MBFC06	7.8	0.5	0.4	0.6	15.9	4.8	M 6×1	11	4	3,500
MBFC08	10.2				20.6	4.6	M 8×1.25	15	5	
MBFC10		0.63	0.53	0.73	20.6	6.4	M10×1.5	19	7	8,800
MBFC12	12.7	1	1	1	25.4	9.5	M12×1.75	23	8	17,000
MBFC16	15	1.27	1.22	1.32	30.1	12.7	M16×2	28	12	26,000

Part Number	Allowable Screw Torque (N·m)	Weight (g)
MBFC04	2.2	2
MBFC06	8.5	10
MBFC08	11	18
MBFC10	28	30
MBFC12	88	50
MBFC16	135	105

MBFC-SUS (Stainless Steel)

Part Number	A	E	S ₁	S ₂	W	H	M	L	w ₁	Clamping Force (N)
MBFC04-SUS	3.8	0.38	0.23	0.53	7.9	2.8	M4×0.7	9.5	3	900
MBFC06-SUS	7.8	0.5	0.4	0.6	15.9	4.8	M6×1	11	4	3,500
MBFC08-SUS	10.2				20.6	6.4	M8×1.25	15	5	

Part Number	Allowable Screw Torque (N·m)	Weight (g)
MBFC04-SUS	2.2	2
MBFC06-SUS	8.5	9
MBFC08-SUS	11	22

Features:

- The eccentric cam screw provides fast and strong clamping.
- The simple design keeps cost low and the small size allows more parts per load.
- Perfect for clamping thin workpieces.
- The brass washer avoids marring workpiece surfaces.
- **MBFC-SUS** is all made from stainless steel, for excellent corrosion resistance.

Notes:

- Clockwise rotation is recommended.
- Locating pin should be on the right of workpiece.
- The cam screw head may project from the hexagonal washer up to 3mm.
- Ensure that there are no interference with tools.

How To Use

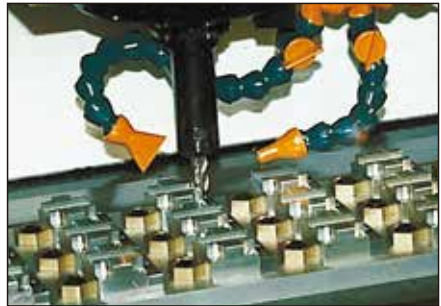
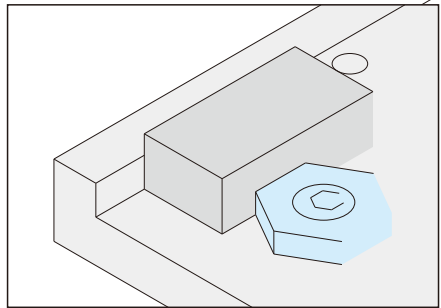

<Installation Instructions>

1. Drill and tap mounting holes as Dimension A (Recommended distance between the mounting hole and the end of the workpiece).
 2. For loading workpieces, tighten the cam screw fully and then loosen it one turn.
 3. Load workpieces and tighten the cam screw.
- *) Ensure that workpieces are clamped firmly before machining.