

HTW

BEARING WASHERS

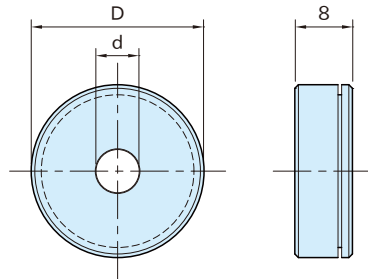

Part Number	d	D	Rated Load (N)	Weight (g)
HTW2406	For M6 screw	24	6,800	21
HTW2508	For M8 screw	25	7,800	22
HTW3010	For M10 screw	30	9,200	34
HTW3512	For M12 screw	35	9,900	46

Body
Steel(SUJ2) Black oxide finished

Features:

- The built-in bearing provides smooth tightening.
- Using the Bearing Washer allows increasing clamping force by 50%.

