

GRL-P-F-SUS

FLAT PLASTIC GUIDE ROLLERS



GRL-P-F-SUS
(Without Stud)



GRL-M-P-F-SUS
(With Stud)

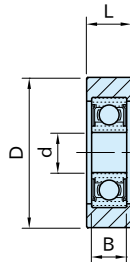

GRL-P-F-SUS

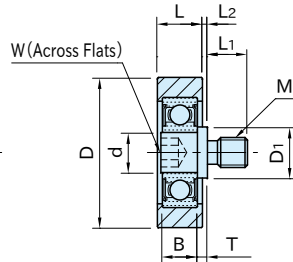

GRL-M-P-F-SUS

Type	Body	Bearing	Stud
GRL-P-F-SUS	Polyacetal plastic	SUS440C	—
GRL-M-P-F-SUS	White	stainless steel	SUS303 stainless steel

GRL-P-F-SUS (Without Stud)

Part Number	D	L	d	B	Bearing Type	Allowable Load (N)	Weight (g)
GRL1304P-F-SUS	13	5	4	4	SMR104ZZ	49	1.7
GRL1404P-F-SUS	14						1.9
GRL1504P-F-SUS	15						2
GRL1805P-F-SUS	18		5		695HZZ	68.6	3.2
GRL1905P-F-SUS	19					3.4	
GRL1906P-F-SUS	19	6	6	5	696HZZ	98	4.7
GRL2006P-F-SUS	20						5
GRL2406P-F-SUS	24						6.1
GRL2506P-F-SUS	25						6.4
GRL2608P-F-SUS	26						13.6
GRL3008P-F-SUS	30	9	8	7	608HZZ	196	16
GRL3508P-F-SUS	35						19.1

GRL-M-P-F-SUS (With Stud)

Part Number	D	L	d	B	M	L ₁	L ₂	D ₁	T	W	Bearing Type	Allowable Load (N)	Weight (g)											
GRL13M4 P-F-SUS	13	5	4	4	M4×0.7	5		6		2	SMR104ZZ	49	2.7											
GRL14M4 P-F-SUS	14												2.9											
GRL15M4 P-F-SUS	15	5	4	4	M4×0.7	5		6		2	SMR104ZZ	49	3											
GRL18M4 P-F-SUS	18												4.4											
GRL19M4 P-F-SUS	19												4.6											
GRL19M5 P-F-SUS	19	6	6	5	M5×0.8	8	1	8	1.5	3	696HZZ	98	7											
GRL19M6 P-F-SUS	19				M6×1								7.4											
GRL20M5 P-F-SUS	20				M5×0.8								7.3											
GRL20M6 P-F-SUS	20				M6×1								7.6											
GRL24M5 P-F-SUS	24				M5×0.8								8.4											
GRL24M6 P-F-SUS	24				M6×1								8.8											
GRL25M5 P-F-SUS	25				M5×0.8								8.7											
GRL25M6 P-F-SUS	25				M6×1								9.1											
GRL26M5 P-F-SUS	26				9								8	7	M5×0.8	12	8	0.5	10	1.5	4	608HZZ	196	19
GRL26M6 P-F-SUS	26														M6×1			1	10.2	2	5			18.2
GRL30M5 P-F-SUS	30														M5×0.8			0.5	10	1.5	4			19
GRL30M6 P-F-SUS	30														M6×1			1	10.2	2	5			20.4
GRL30M6LP-F-SUS	30	M6×1	12	0.5		10.2	1.5	4	20.8															
GRL35M5 P-F-SUS	35	M5×0.8	1	10		1.5	4	23																
GRL35M6 P-F-SUS	35	M6×1	12	0.5		10.2	1.5	5	2	5	23.6													
GRL35M6LP-F-SUS	35								2	5	23.7													

Feature

The plastic body provides silent running.

Technical Information

Heatresistant Temperature 105°C

Notes

- Roller pin for “Without Stud” type should be prepared by the customer.
- Do not use in applications where impact load or axial load is applied.
- “Allowable Load” mentioned above means allowable radial load based on the test of rotating the roller a million times at the speed of 300min⁻¹. Consider the above load values as reference since load capacity varies with use conditions or environments.

How To Use
