

FLT-R / FLT-A VERTICAL TIGHTENERS

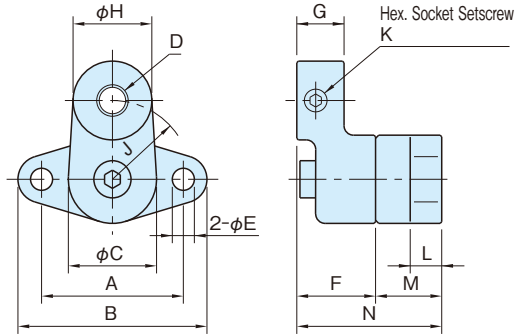

Part Number	Body	Arm	Locking Element
FLT45R	Cast iron (FCD450) Powder baking finish	Steel (S50C) Powder baking finish	Steel (S50C)
FLT45A	Black	Black	
FLT90R	Cast iron (FC250) Powder baking finish	Cast iron (FCD450) Powder baking finish	Steel (S45C)
FLT90A	Black	Black	

Part Number		No. of Teeth	A	B	C	D	E	F	G	H	J	K
FLT45R	FLT45A	15	45	60	28	M10×1.5	7.5	25	15	25	25	M5×0.8 - 6L
FLT90R	FLT90A	24	90	115	55	M20×2.5	12	46	28	50	55	M8×1.25-14L

FLT45R **FLT90R** (Adjustable Type)

Part Number	L	M	N	Weight (g)
FLT45R	10	21	46	280
FLT90R	13	25	71	1,600

FLT45A **FLT90A** (Swing Type)

Part Number	Max. Swing Angle	Max. Tension	L	M	N	Weight (g)
FLT45A	70°	45.8N	10	21	46	280
FLT90A	60°	145 N	18	39	85	2,000

Caution on **FLT45A** **FLT90A** (Swing Type)

- Initial tension is "0"N.
- Do not apply a counterclockwise force to the arm when it is engaged with the locking element, to avoid possible damage to the return spring.
- FLT**A** Swing Tighteners for counterclockwise arm swing is available on request.

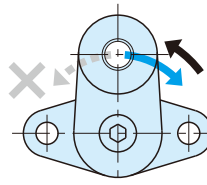

Clockwise force applied to the arm allows generating tension (max. torsion angle and max. tension must be considered in installation).