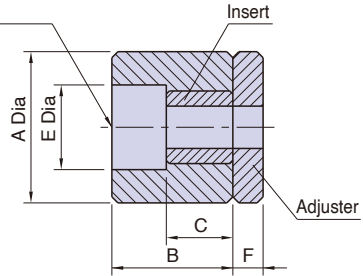

FD**FIXED DAMPERS**For D-Socket-Head
Cap Screw

[Body]

Material : Polyurethane rubber

Hardness : Shore A75

Color : Black

[Insert]

Material : STKM13C steel

Finish : Zinc plate

[Adjuster]

Material : Steel

Finish : Black oxide

Part Number	A	B	C	D	E	F	Weight (g)
FD15	15	13	7	M4	9	—	4
FD15× 3						3	8
FD15× 7						7	14
FD15×12						12	20
FD20	20	16	8	M5	11	—	8
FD20× 4						4	18
FD20× 9						9	29
FD20×16						16	45
FD25	25	20	11	M6	14	—	16
FD25× 5						5	36
FD25×12						12	64
FD25×20						20	96
FD25×30	30	20	11	M6	14	30	135
FD30						—	27
FD30× 5						5	55
FD30×12						12	94
FD30×20	30	20	11	M6	14	20	139
FD30×30						30	195

Part Number	A	B	C	D	E	F	Weight (g)
FD35	35	25	14	M 8	20	–	48
FD35× 7						7	100
FD35×15						15	159
FD35×25						25	233
FD35×38						38	330
FD40	40	25	14	M 8	20	–	56
FD40× 7						7	117
FD40×15						15	187
FD40×25						25	274
FD40×38						38	385

Feature:

- The built-in insert increases durability.
- Full-face shock dampening
- Polyurethane rubber has higher elasticity than metal spring or rubber so even smaller ones can provide a big repelling force.
Thanks to high resistance to material fatigue, the elasticity can hardly be decrease.
- By applying the material characteristic of polyurethane to impact buffer, the damper has high shock absorption despite being small.
- Easy handling compared to oil buffer
- Long-term usage without any maintenance

Note:

Use in hot and/or humid environments is not recommended.

■ Characters of polyurethane rubber

- Hydrolysis resistance
Hot and humid air, warm water and moisture may hydrolyze and deteriorate polyurethane rubber.
- Solvent resistance
Aliphatic system solvents slightly swell polyurethane rubber, but highly polar chlorinated hydrocarbon, aromatic system solvents, ester and ketone swell it a lot.

Application Example

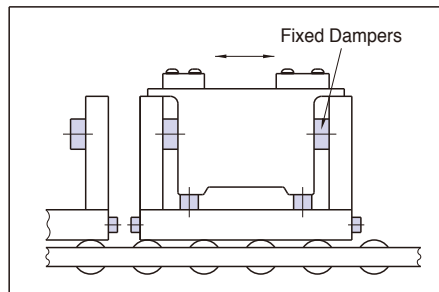

■ Application

- Stopping for reversing gear
- Transfer equipment for assembling line
- Stopping for turntable
- Inverting part of machine tool
- Slide end of machine table
- Reciprocating moving parts
- Conveyor
- Sliding door opening and shutting ends
- Pneumatic cylinder of various transfer equipments