

# EAG-SA

# ERGOSTYLE BRIDGE HANDLES (Antimicrobial)



Original ELES Model EBP-SAN



EAG-SA



EAG-SA-CL

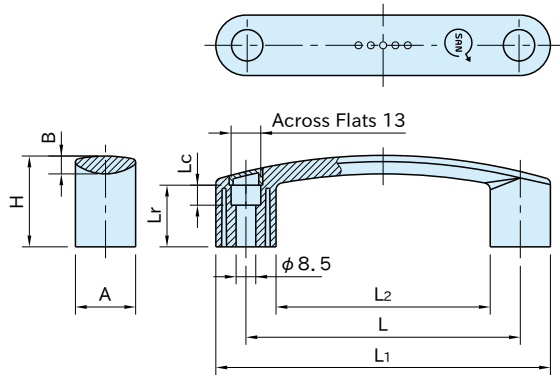

Handle	Cap
Glass-fiber reinforced polyamide plastic	Polyamide plastic
Black matte	Black matte
White matte	White matte

Black	White	L	L <sub>1</sub>	L <sub>2</sub>	H	A	B	L <sub>r</sub>	L <sub>c</sub>	Weight (g)
Part Number	Part Number									
<b>EAG140-SA</b>	<b>EAG140-SA-CL</b>	117±0.5	144	91	39	26.5	8.5	26.5	8.5	58
<b>EAG200-SA</b>	<b>EAG200-SA-CL</b>	179±1	208.5	150.5	51	29	9.5	35	16	95

## Technical Information

Working temperature max.130°C min.-30°C

### Antimicrobial Activity

Material samples have been tested according to JIS Z 2801. The following microbe strains have been used for the tests:

- Escherichia Coli ATCC 25922
- Staphylococcus Aureus ATCC 25923
- Klebsiella Pneumoniae ATCC 13883
- Pseudomonas Aeruginosa ATCC 27853
- Candida Albicans ATCC 10231

### Strength Data

Size	F <sub>H</sub> [N]	F <sub>V</sub> [N]	L <sub>H</sub> [J]	L <sub>V</sub> [J]
<b>EAG140</b>	2700	1800	10	4
<b>EAG200</b>	2200	1500	16	9

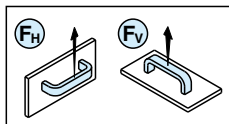

### Tensile Stress

The stated F<sub>H</sub> and F<sub>V</sub> values denote the average of the breaking loads measured in a breaking test under normal working conditions.

## Features

- Silver ions added to the polyamide plastic help to deaden sundry germs to inhibit their development.
- After cleaning, the antibacterial properties remain unchanged.
- Perfect for installation on equipment and instruments used in hygienic environments.
- Arched design for better gripping
- Can be mounted with socket-head cap screws and covered with supplied caps.

## Notes

- Use in hot or highly humid circumstances can deteriorate the plastic material properties.
- A cap and a knob are packed separately and not delivered in assembly.

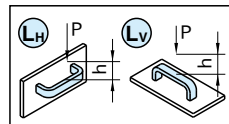

### Impact Strength

The stated L<sub>H</sub> and L<sub>V</sub> values denote the average of the breaking loads measured in a drop test with a load of 6.7N.