

CTR / CTRS CROWN PULLEYS



CTR
(Plastic)



CTRS
(Steel)

Type	Body	Bearing	Retaining Ring
CTR	Glass-fiber reinforced polyamide plastic Black	Steel	-
CTRS	Steel (S45C) Electroless nickel plated finish		Steel

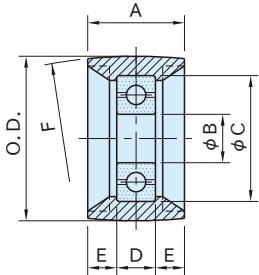

CTR 1535 to 2550
(Plastic)

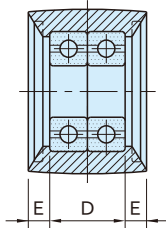

CTRS 3050 to 5560
(Plastic)

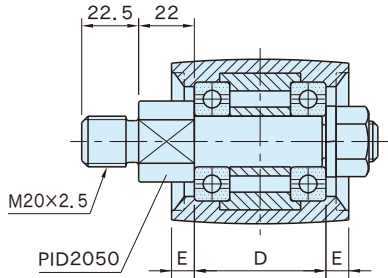

CTR 6065
(Plastic)

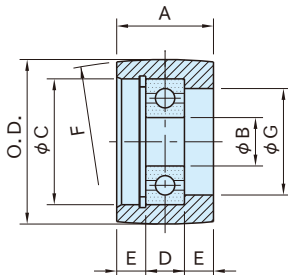

CTRS 1535 & 2045
(Steel)

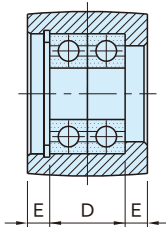

CTRS 3050 & 4550
(Steel)

CTR (Plastic)

Part Number	O.D.	A	B	C	D	E	F	Bearing	Weight (g)	Proper Idler Pin
CTR1535	34	20	10	26	8	6	R100	6000ZZ	22	PID1008
CTR2045	43	24.5	15	35	11	6.75	R150	6202ZZ	55	PID1511
CTR2550	48	30				9.5	R200		65	
CTR3050	48	34.5	15	35	22	6.25	R200	6202ZZ×2	110	PID1522
CTR3075	73								150	
CTR4550	48								49	
CTR5560	58	60	20	47	28	16	R400	6204ZZ×2	250	PID2028
CTR6065	64	70			52	9			950	PID2050(included)

CTRS (Steel)

Part Number	O.D.	A	B	C	D	E	F	G	Bearing	Weight (g)	Proper Idler Pin
CTRS1535	34	20	10	26	8	6	R100	22	6000ZZ	60	PID1008
CTRS2045	43	25	15	35	11	7	R150	28	6202ZZ	140	PID1511
CTRS3050	48	35	15	35	22	6.5	R200	28	6202ZZ×2	290	PID1522
CTRS4550		49				13.5				395	

- **CTR** type is available with moulded-in ball bearing.
- The ball bearing of **CTRS** type is locked by a retaining ring.
- **CTR6065** Pulley comes with a **PID2050** Idler Pin.

Technical Data

Allowable Bearing Radial Loads(N)
(for 3,000 hours of average service life)

Bearing	Speed (min ⁻¹)							
	100	500	1000	1500	2000	2500	3000	3500
6000ZZ	1370	1090	640	560	500	470	440	420
6202ZZ	2310	1350	1080	940	850	790	740	710
6202ZZ×2	3740	2180	1740	1520	1370	1280	1200	1140
6204ZZ×2	6240	3650	2900	2530	2300	2130	2010	1910