

CP740

RETRACTABLE ONE-TOUCH CLAMPING LOCATORS

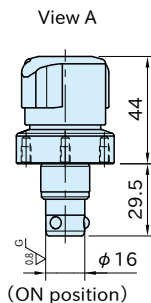

(OFF position) (ON position)

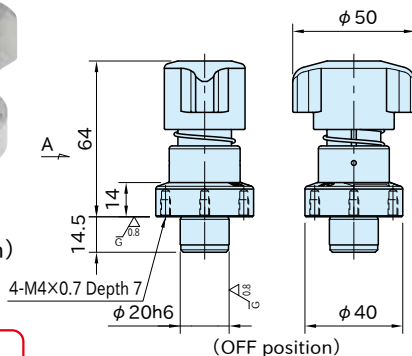
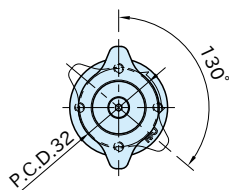

★Key Point

Retractable shaft allows sliding movement

Body	Shaft	Cam Shaft	Knob	Ball	Spring	
SUS303 stainless steel	Pre-hardened steel Electroless nickel plated	SCM415 steel Electroless nickel plated Carburized-hardened	SCS13 stainless steel (Equivalent to SUS304)	SUS440C stainless steel	Equivalent to SWOSC-V steel	SUS304WPB stainless steel

Part Number	Clamping Force (N)	Weight (g)	Locating Receivers
CP740-1640LA	2500	350	CP745-1640L, CP745-1640S

How To Use

■ Mounting Hole Dimension

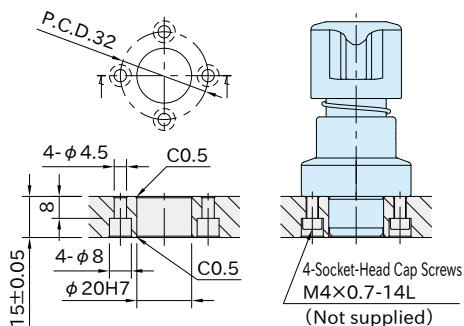

Reference

How To Use RETRACTABLE ONE-TOUCH CLAMPING LOCATORS