

CP735

ONE-TOUCH FLEX LOCATOR BUSHINGS



(Tapered Type)



(Straight Type)

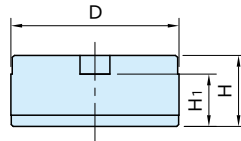
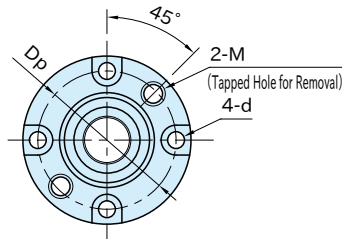

Type	Body	Tapered Bushing
CP735-L	SCM440 steel Black oxide finished	SCM440 steel Nitrocarburized
CP735-S	Quenched & tempered	-

Part Number	Type	D (g6)	H	d	H ₁	D _p	M	Lifting Force (N)*	Weight (g)
CP735-0939L	Tapered	38	15	4.5	10	30	M5×0.8	300	100
CP735-0939S	Straight							-	101
CP735-1246L	Tapered	45	19	5.5	14	37	M6×1	450	179
CP735-1246S	Straight							-	184
CP735-1656L	Tapered	55	24	5.5	18	45	M6×1	680	337
CP735-1656S	Straight							-	341

*) The lifting force is the power of the inner spring of the body to push up the movable tapered bushing. For maximum loading weight and locating repeatability, see How To Use ONE-TOUCH FLEX LOCATORS (Hexagon Head / Cam Handle).

How To Use

Mounting Hole Dimension

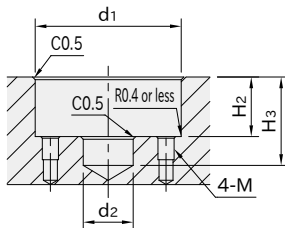

Spacing Tolerance

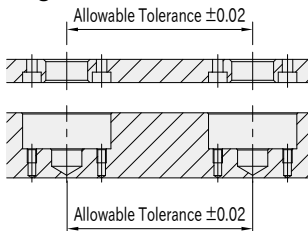

Size	d ₁ (H7)	H ₂ (±0.05)	d ₂	H ₃	M
CP735-0939	38	15.5	13	23	M4×0.7
CP735-1246	45	19.5	16	28	M4×0.7
CP735-1656	55	24.5	20	34	M5×0.8

Related Product

- **CP730** ONE-TOUCH FLEX LOCATOR CLAMPERS (Hexagon Head)
- **CP731** ONE-TOUCH FLEX LOCATOR CLAMPERS (Cam Handle)
- **CP735-P** ONE-TOUCH FLEX LOCATOR (PROTECTING COVERS)

Reference

How To Use ONE-TOUCH FLEX LOCATORS (Hexagon Head / Cam Handle)