

CP701

EXTENDABLE WORK LOCATORS



Body & Piston	Crank shaft
Steel (S45C) Quenched and tempered Black oxide finish	Steel (S45C) Black oxide finish

3-M For Hex. Socket
Head Cap Screws

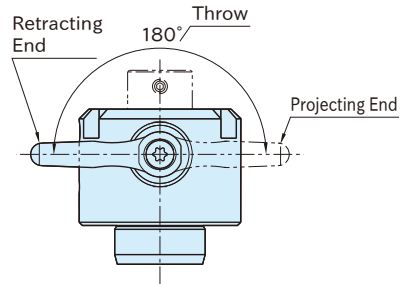
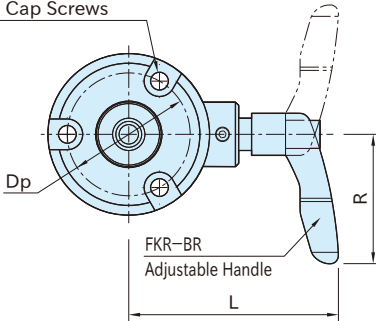

The handle position can be changed freely, clockwise or counterclockwise.

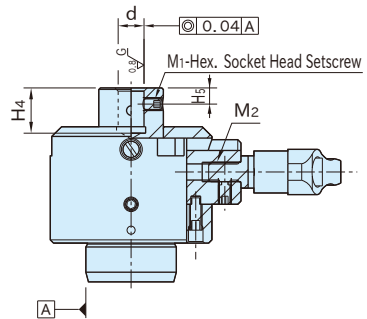
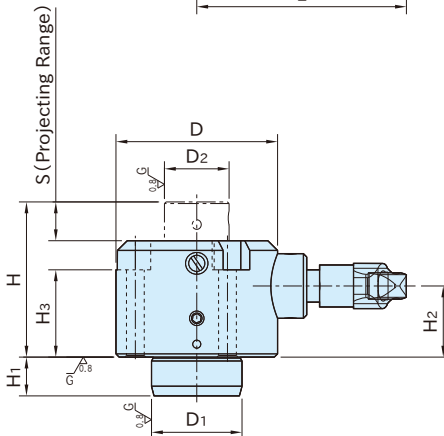

Projected Mode

Part Number	d (G7)	D ₂	H ₄	H	S	D ₁ (g6)	H ₁	D	M	H ₃	D _p	R	M ₂
CP701-20050	8	20	14	48	12	28	12	50	M5	27	38	40	M6×1 12 deep
CP701-30063	12	30	16	61	15	42	14	65	M6	31	52	65	M8×1.25 7deep

Part Number	L	H ₂	M ₁	H ₅	Adjustable Handles	Allowable Operating Load (N)*	Max. Workpiece Weight (kg)**	Weight (kg)
CP701-20050	65	22	M4×0.7-5L	5	FKR6×10-BR	170	250	0.59
CP701-30063	87.5	26	M5×0.8-8L	6	FKR8×15-BR	210	300	1.31

*) Allowable load to operate the handle

***) Max. weight that allows the locating pin to project and provide workpiece centering

How To Use

Extended Application

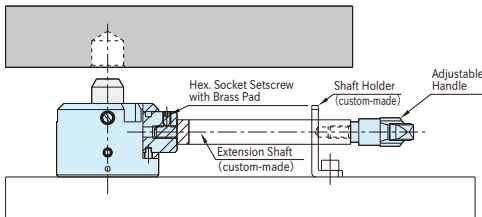

With an extension shaft and a shaft holder prepared separately, the handle control can be easily done even when small space is available under the workpiece.

Locating-Pin Mounting

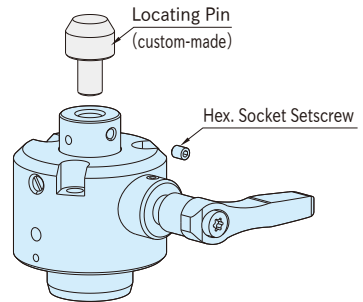

Projected Mode

A locating pin can easily be mounted by using a hex socket setscrew when the piston is fully projected (locating pins must be prepared separately).

Locating-Pin Head Dimensions

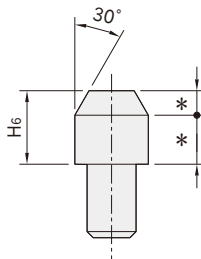

Determine the dimensions marked with an asterisk considering a clearance set between the workpiece and the locating guides. When the taper angle is determined to be smaller than 30° (recommended), set the clearance smaller.

Type	H ₆
20050	12 or less
30063	15 or less

Features

- Can support heavy workpieces made from steel or cast iron
- No tools needed
- The handle is **FKR** Metal Adjustable Handle. The handle position is freely adjustable.
- Different locating pins can be mounted depending on workpiece's locating holes.
- The piston stays locked when it is fully projected or retracted until the handle is operated again.