

# CP700

# WORK LOCATORS

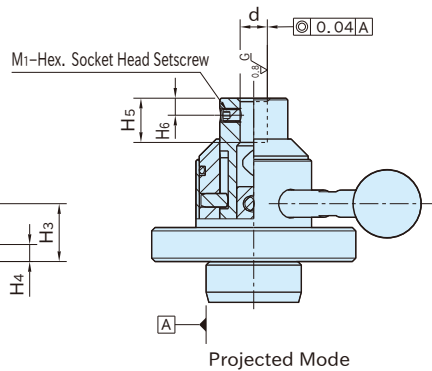

Body	Piston	Handle	Ball Knob
Steel (S45C) Quenched and tempered Black oxide finish	Steel (SCM440) Quenched and tempered Black oxide finish	Steel (S45C) Black oxide finish	ABS resin Black

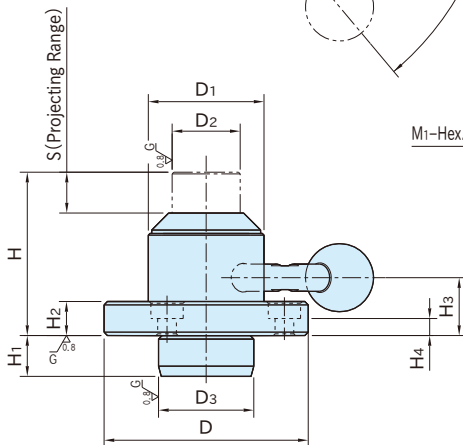
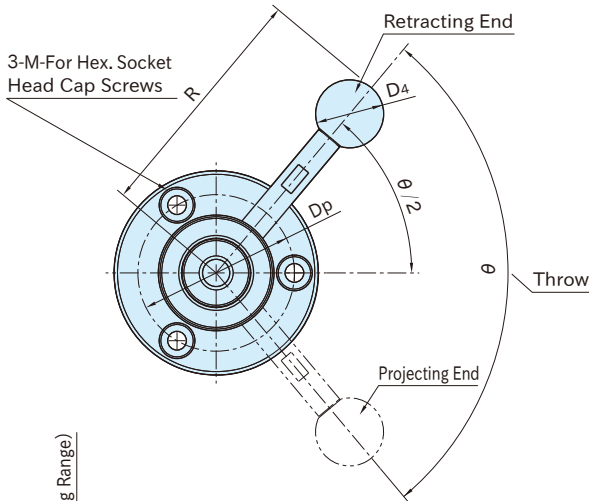

Part Number	d (G7)	D <sub>2</sub>	H <sub>5</sub>	H	S	D <sub>3</sub> (g6)	H <sub>1</sub>	D	D <sub>1</sub>	H <sub>2</sub>	M	H <sub>4</sub>	D <sub>p</sub>	R
<b>CP700-20050R</b>	8	20	13	48	12	28	12	60	34	10	M5	5	46	71
<b>CP700-30063R</b>	12	30	15	61	15	42	14	80	48	13	M6	7	63	94

Part Number	D <sub>4</sub>	H <sub>3</sub>	θ	M <sub>1</sub>	H <sub>6</sub>	Allowable Operating Load (N)*)	Max. Workpiece Weight (kg)**)	Weight (kg)
<b>CP700-20050R</b>	20	17	100°	M4×0.7-5L	5	150	250	0.42
<b>CP700-30063R</b>	25	23	90°	M6×1 -8L	8	200	300	1.04

\*) Allowable load to operate the handle

\*\*\*) Max. weight that allows the locating pin to project and provide workpiece centering

## How To Use

**Present Method**

Galling and damage caused

**Imao Method**

No galling caused

Locating Guides

The locating pin gets projected only after the workpiece is set on supports. This allows loading and unloading the workpiece smoothly, with no galling.

Get the locating pin projected to locate the workpiece after it is roughly positioned with the help of locating guides.

Retracted Mode

Projected Mode

↔ Workpiece Centering

1. Rough Locating With Locating Guides
2. Pin Projection  
↑ Pin Gets Projected
3. Completed Locating