

CP160

CLAMPING MODULES (Hook)

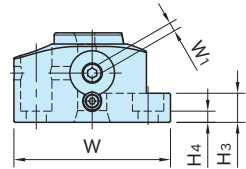
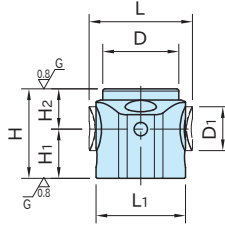
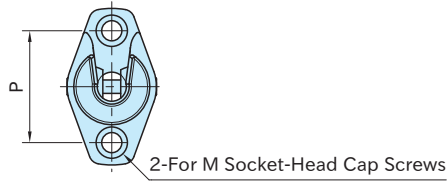

Note: The drawing shows CP160-R. The hex. socket for locking screw (W₁) is on the other side in CP160-L.

Body	Clamping Nut	Locking Screw
SCM440 steel Induction hardened Black oxide finished Precision ground	SCM440 steel Quenched and tempered Black oxide finished	SCM435 steel Quenched and tempered Black oxide finished

Part Number	D	H (±0.01)	D ₁	L	H ₁	H ₂	W	L ₁	H ₃
CP160-08040R	34	40	20	46	22	18	70	40	13
CP160-08040L									
CP160-12063R	52	63	30	69	35	28	100	60	20
CP160-12063L									
CP160-16080R	70	80	40	93	44	36	140	80	26
CP160-16080L									

Part Number	M	P	H ₄	W ₁	Clamping Force (kN)	Allowable Screw Torque (N·m)	Weight (kg)
CP160-08040R	M 8	50	5	4	8	8	0.4
CP160-08040L							
CP160-12063R	M12	75	8	6	15	22	1.4
CP160-12063L							
CP160-16080R	M16	100	10	8	25	50	3.2
CP160-16080L							

Technical Information

Allowable Cutting Force & Workpiece Weight of CLAMPING MODULES (Hook)

Related Product

- [CP157](#) Tapered Bushings
- [CP165-LH](#) Tapered Clamping Screws (Hook)
- [CP165-L](#) Tapered Clamping Screws
- [CP166-H](#) Clamping Screws (Hook)
- [CP166](#) Clamping Screws

How To Use

- Use **CP157-L** Tapered Bushing (Accurate) for precise locating.
- Use **CP157-S** Tapered Bushing (Standard) for rough locating.

■ Mounting-Hole Dimension

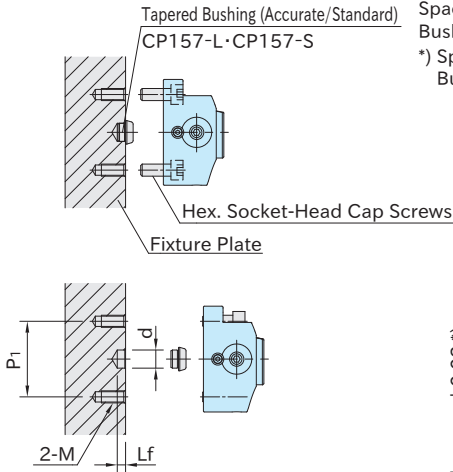

Size	d (H7)	Lf	M	P ₁
CP160-08040	12	5.5	M 8×1.25	50
CP160-12063	18	6.5	M12×1.75	75
CP160-16080	22	8	M16×2	100

Note: The tolerance of dimension "d" for Tapered Bushings (Standard) should be $^{+0.1}$.

■ Spacing Tolerance

Spacing tolerance should be ± 0.02 for Tapered Bushings (Accurate).

*) Spacing tolerance should be ± 0.1 for Tapered Bushings (Standard).

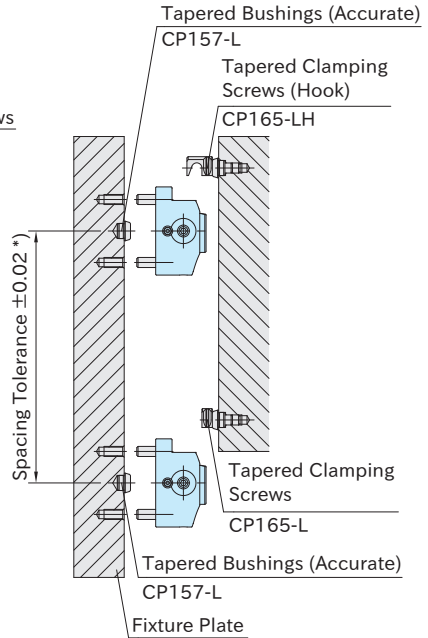

■ Layout

Use CP160-R for tightening from right side,
CP160-L for left side.

