

# CD-N-ATEX

# OIL CIRCULATION SIGHTS (ATEX-Compliant)

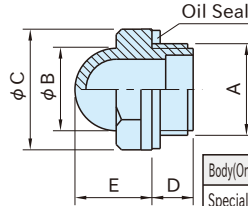

ELESA Original Design HCFE-EX

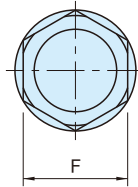

Body(One-Piece Molded)	Oil Seal
Special clear polyamide plastic (PA-T)	Nitro rubber (NBR)

Part Number	A	B	C	D	E	F	Screw Torque (N·m)	Weight (g)
<b>CD-12N-ATEX</b>	G <sup>3</sup> / <sub>8</sub>	15	22.5	7.5	13	19	3~5	4
<b>CD-15N-ATEX</b>	G <sup>1</sup> / <sub>2</sub>	19	26	10.5	16	22	4~6	5
<b>CD-20N-ATEX</b>	G <sup>3</sup> / <sub>4</sub>	25	31.5		19.5	27	6~8	8

### Notes:

- Do not mount these plugs on the water tank to avoid them from expanding due to water absorption.
- Unresistant to gasoline and alcohol.

### Technical Information:

Operating Temperature : Between -20°C and 80°C

Part Number	ATEX Identification
<b>CD-12N-ATEX</b>	<b>II 2GD Ex h X</b>
<b>CD-15N-ATEX</b>	
<b>CD-20N-ATEX</b>	

ATEX identification is marked on the side of the product.