

**BJ744**      **COUPLING NUTS**

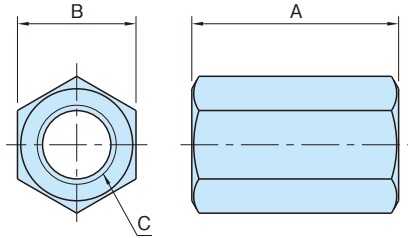

Body
Steel (S45C)
Quenched and tempered
Black oxide finish
Heat treated to HRC33-39

Part Number	A	B	C	Weight (g)
<b>BJ744-06001</b>	18	10	M 6×1	8
<b>BJ744-08001</b>	24	13	M 8×1.25	30
<b>BJ744-10001</b>	30	17	M10×1.5	50
<b>BJ744-12001</b>	36	19	M12×1.75	60
<b>BJ744-16001</b>	48	24	M16×2	90
<b>BJ744-20001</b>	60	30	M20×2.5	130
<b>BJ744-24001</b>	72	36	M24×3	375

**Application Example**

