

BJ736-A

SWIVEL SCREW CLAMPS, Type A

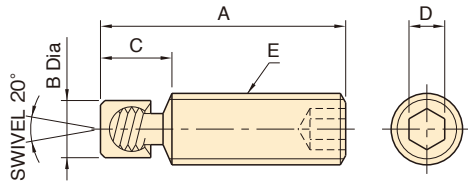

[Body]

Material : SCM435 steel

Heat Treat : Quenched and tempered

Finish : Black oxide finish

[Foot]

Material : SUM24L steel

Finish : Black oxide finish

Part Number	A	B	C	D	E	Allowable Screw Torque (N·m)	Clamping Force (N)	Weight (g)
BJ736-06015A	15	4.8	7	3	M 6x1	2.5	2,100	4
BJ736-06020A	20							5
BJ736-06025A	25							6
BJ736-06040A	40							10
BJ736-08020A	20	6.4	9	4	M 8x1.25	6.5	4,100	8
BJ736-08025A	25							10
BJ736-08040A	40							15
BJ736-08050A	50							20
BJ736-10020A	20	7.6	10	5	M10x1.5	13	6,500	13
BJ736-10025A	25							15
BJ736-10040A	40							25
BJ736-10050A	50							30
BJ736-10075A	75							45
BJ736-12040A	40	9.9	12	6	M12x1.75	20	8,300	35
BJ736-12050A	50							45
BJ736-12075A	75							65
BJ736-12100A	100							90
BJ736-16050A	50	12.7	16	8	M16x2	50	15,600	75
BJ736-16075A	75							110
BJ736-16100A	100							150
BJ736-16125A	125							190



Note:

Feet have lefthand threads to positively prevent backout when turning the screw counterclockwise.