

BJ132-BN

HOOK-CLAMP ASSEMBLIES WITH FLANGED HOLDER

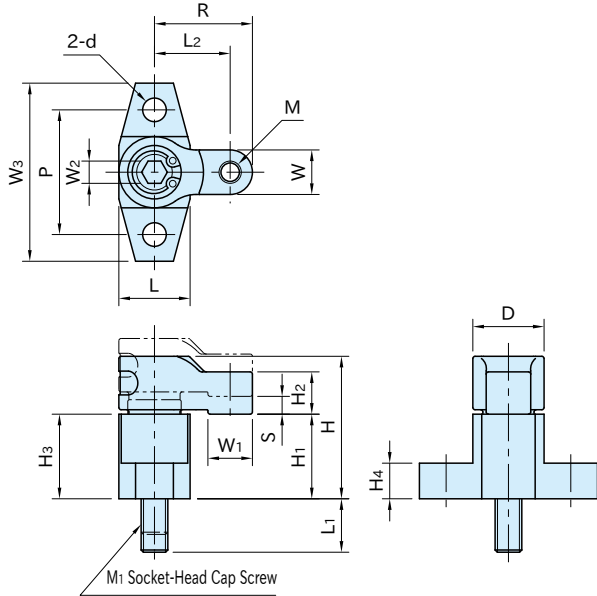

Clamp Body	Holder
SCM440 steel Quenched and tempered Black oxide finished	S45C steel Quenched and tempered Black oxide finished

Part Number	H ₁	S (Clamping Stroke)	W ₁	M	L ₂	R	W ₃	L	M ₁	L ₁ (max)	d	H ₄	P	H	H ₃	D	W	H ₂	W ₂
BJ132-04018BN	16	3	8	M4×0.7	14	18	34	14	M4×0.7-30L	11	4.3	6	24	26	16	14	8	7.5	3
BJ132-06022BN	19	4	10	M5×0.8	17	22	40	16	M6×1 -35L	12	5.3	8	28	32	19	16	10	9.5	5

Part Number	Clamping Force (kN)	Allowable Screw Torque (N·m)	Weight (g)
BJ132-04018BN	2	2.7	48
BJ132-06022BN	3.5	7	79

Feature

- Ideal for low height clamping.
- The hook clamp is designed to move up and down in conjunction with the tightening screw, for prevention of galling in the hook-clamp holder.

Part Number	M ₂	M ₃	P ₂
BJ132-04018BN	M4×0.7 Depth 13	M4×0.7	24
BJ132-06022BN	M6×1 Depth 14	M5×0.8	28

How To Use

