

THRUST CLAMPS INSTRUCTIONS [QLRC]

Note

The product comes with a bar inserted for protection.
 Replace the bar with your clamping shaft before use.



The above photo shows the clockwise clamping style.

How To Change Clamping Bars

1. Remove the included bar for protection at the unclamping state.
2. Insert your own clamping shaft throughly from the side where the lever is mounted.
3. In case it is hard to insert a clamping shaft, spread the internal split collet with a conical-end bar to open the split collet. Then, try to insert the clamping bar to the clamp at the unclamping state.

Step 1

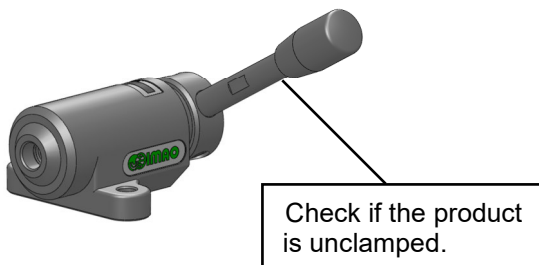

Step 3

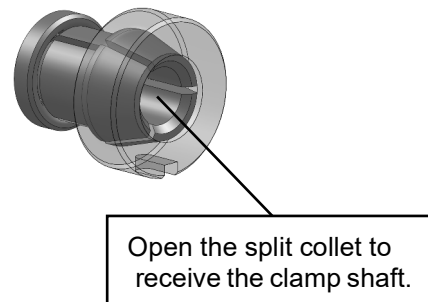

Step 2

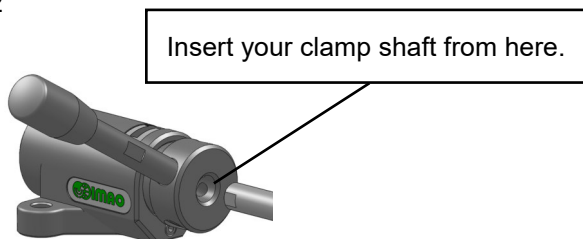

IMAO CORPORATION

【CONTACT US】

Export Sales Team

<https://www.imao.com/en/contact-us/>