

## ONE-TOUCH SPINDLE LOCKS INSTRUCTIONS

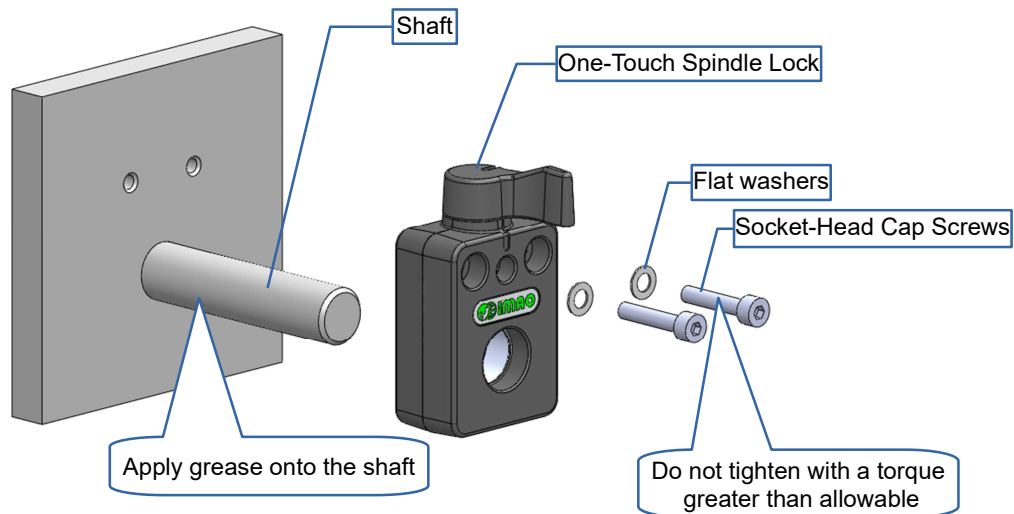

1. Remove burrs and dusts on the shaft to prevent failures caused by damages while mounting the product to the shaft. Apply grease in a thin layer to the sliding part of the shaft and the bore of the product.
2. Put the included flat washers to the product.
3. Tighten the socket-head cap screws with the allowable screw torque as follows.
  - \*) Tightening with torque greater than the allowable screw torque may cause deformation and malfunction of the product.
  - QCSPL04 Size (M4 Screw) . . . 1.5 N·m
  - QCSPL09 Size (M5 Screw) . . . 3.0 N·m
4. Ensure that the shaft rotates or slides smoothly after mounting the product. If the operation is not smooth, remove the product and mount it to the shaft again to make sure the shaft goes through the product straightly.

IMAO CORPORATION  
 【CONTACT US】  
 Export Sales Team  
<https://www.imao.com/en/contact-us/>