

LSM LINEAR-MOTION STOPPERS INSTRUCTIONS

● How To Operate

- As the handle is turned to the clamping position, it directly clamps the linear rail.

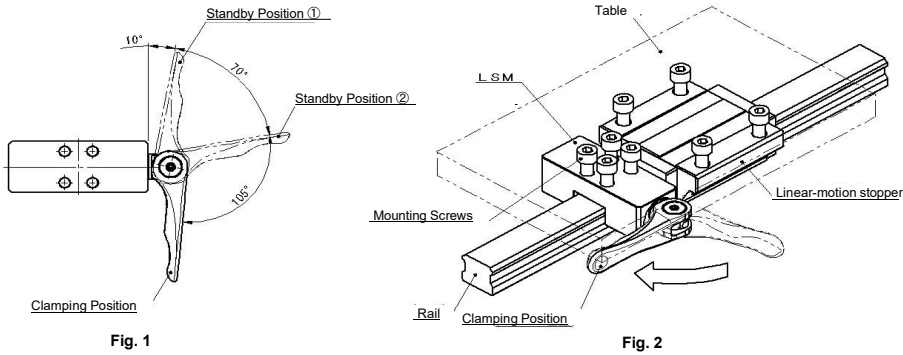

● Notes

- Turn the handle fully to the clamping position to complete a clamping. With the handle position within the traveling range, the stated clamping force will not be achieved. (Refer to the above Fig. 1 & 2.)
- If the friction coefficient between the rail and the stopper is significantly low by too much oil or other factors, it can decrease the holding force of the stopper.
- The stopper can skid with big impact load.
- Regular lubrication with grease on cam part of the handle is recommended. (Refer to the right drawing.)
- Do not decompose or remodel this product.

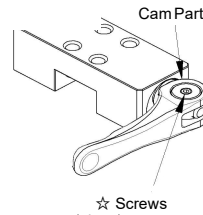

⚠ Never loosen the screws in the right drawing. (Clamping mechanism can be unworkable.)

● How To Mount

- Put the linear-motion stopper of unclamping mode (※1) onto the linear-rail.
 - Fit the mounting screws provisionally to mount the linear-motion stopper on table.
 - Hold the linear-rail lightly with linear-motion stopper. (Refer to fig. 3.)
 - Adjust the clearance between linear-motion stopper and rail. (Refer to fig. 4.)
 - Fix the mounting screw firmly to install the linear-motion stopper finally.
 - Unclamp the linear-motion stopper (※1) and check if there is any interference between it and rail or base.
- ※ 1: The handle should standby at ① or ②. (Refer to the above fig.1.)

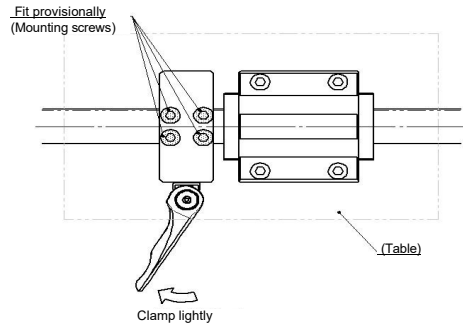

Fig. 3

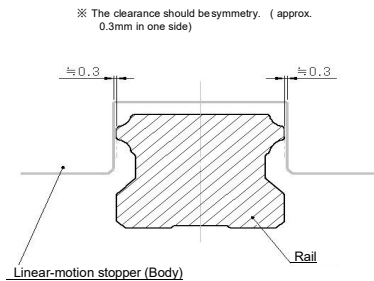

Fig. 4

● How To Adjust the Handle Position (Fig. 5 & 6)

- Loosen the setscrew in the handle mounting surface (Approx. a half-turn should be enough.)
- Loosen the setscrew in the bottom surface of the body until the handle rotates freely.
- Turn the handle to a desired position. The handle can be positioned every 90 degrees.
- Tighten the setscrew in the bottom surface of the body. After the setscrew is fully tightened, loosen it 1/4 turn.
- Tighten the setscrew in the handle mounting surface.

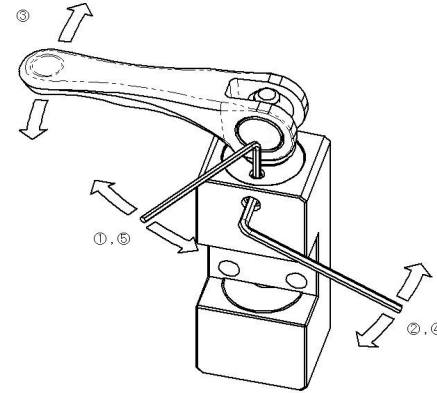

Fig. 5

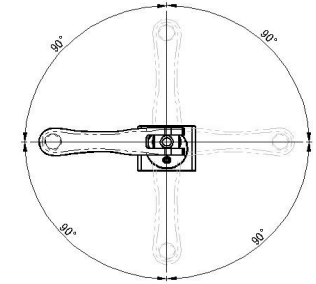

Fig. 6

IMAO CORPORATION

[CONTACT US]

Export Sales Team

<https://www.imao.com/en/contact-us/>