

ADJUSTABLE-TORQUE WRENCHES[CP-TCW] INSTRUCTIONS

■ How to Set Torque

※ The preset torque is roughly set to its maximum tightening torque.

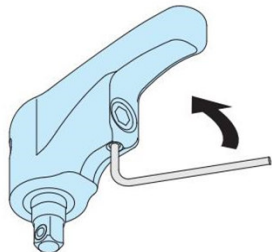

1. Loosen the locking screw of the back side.

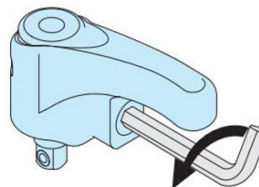

2. Turn the torque-adjusting screw to the left to adjust the torque.

*** Please adjust the torque-adjusting screw within the torque range.
Do not overloosen or overtighten the screw.**

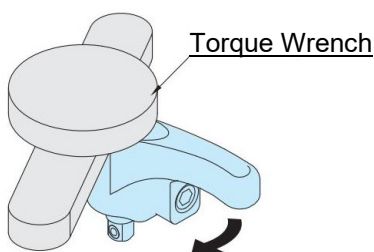

3. Measure the torque with a torque wrench.

- Connect a torque wrench to the Adjustable-Torque Wrench.
- Turn the handle in the tightening direction and fine-adjust the depth of torque-adjusting screw to reach to the handle clicking position at the desired torque.

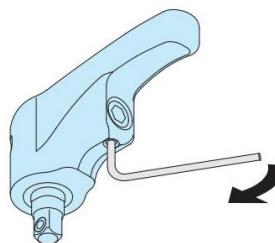

4. Tighten the locking screw.

Size		Torque Range (N·m)
CP-TCW	6	1~3.5
	8	2~5.4
CP-TCW-S	10	3~8

■ Note

- For initial several thousand operations, the tightening torque will decrease.
(See the graph below)
- Measure the torque regularly, and fine-adjust the depth of torque-adjusting screw if needed.
- The tightening torque can vary. (Max. +/-15%)
Not recommended for precise torque management.

Torque Performance Graph

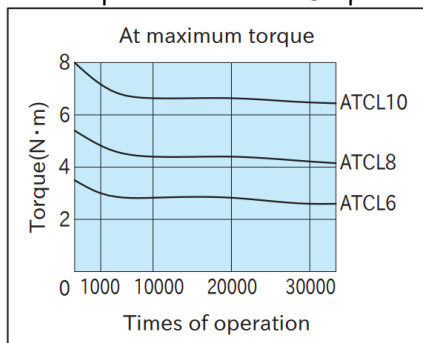

■ Exploded View

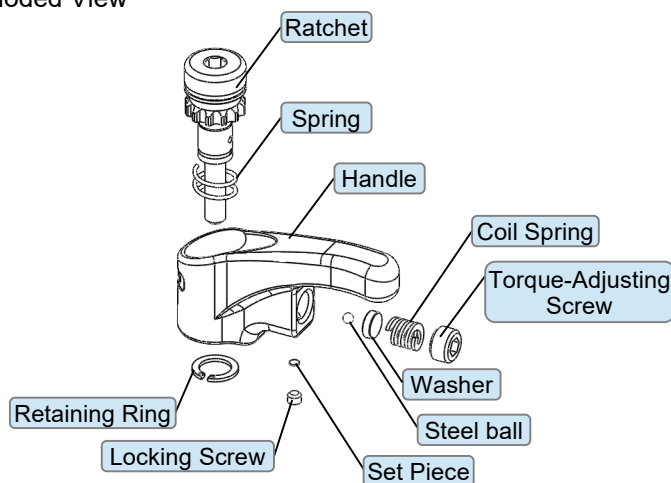

IMAO CORPORATION
【CONTACT US】

Export Sales Team

<https://www.imao.com/en/contact-us/>